

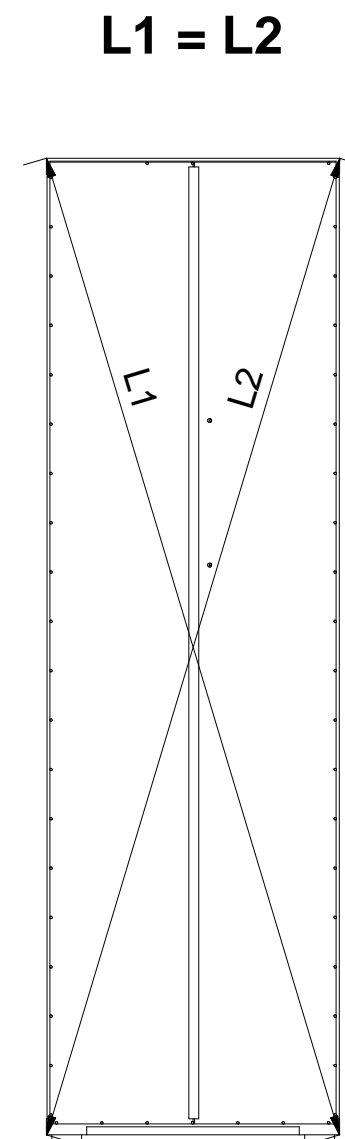

OXFORD 9

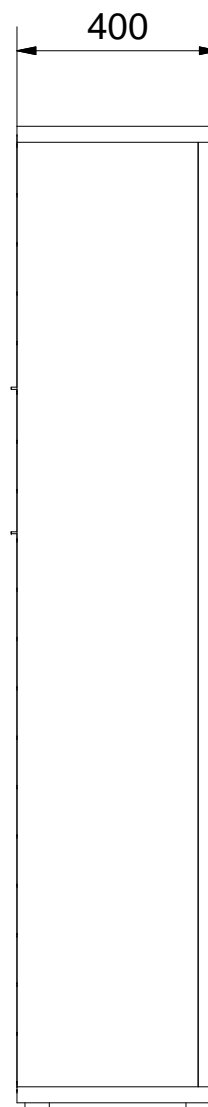

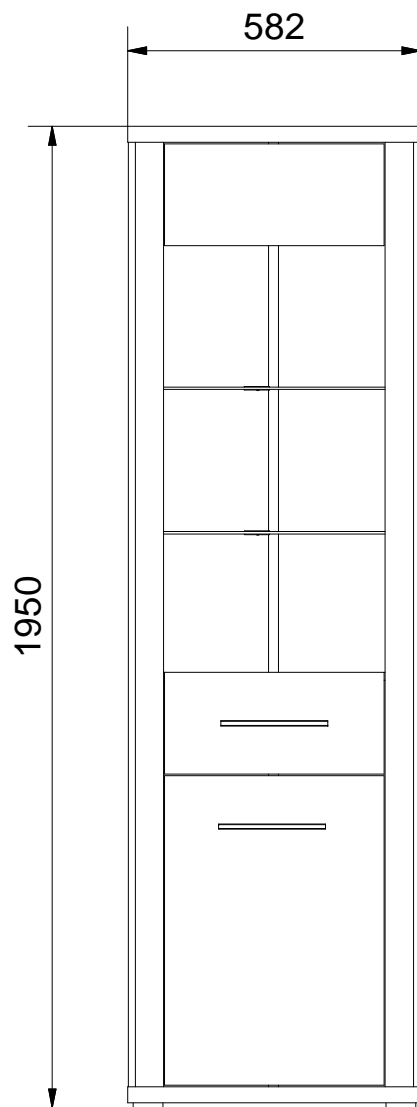
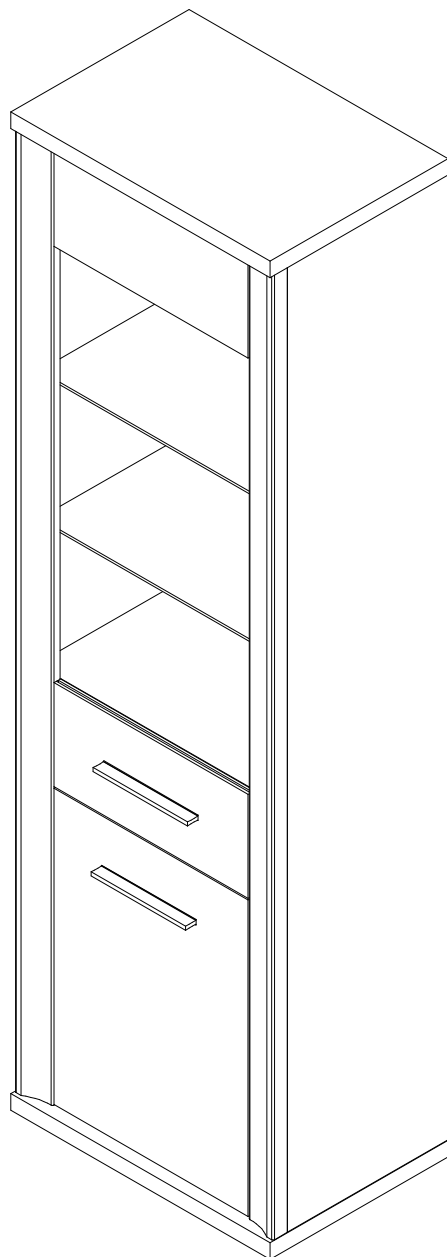

OXFORD 9

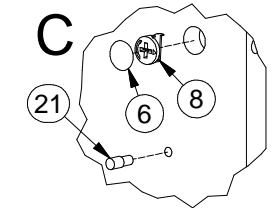
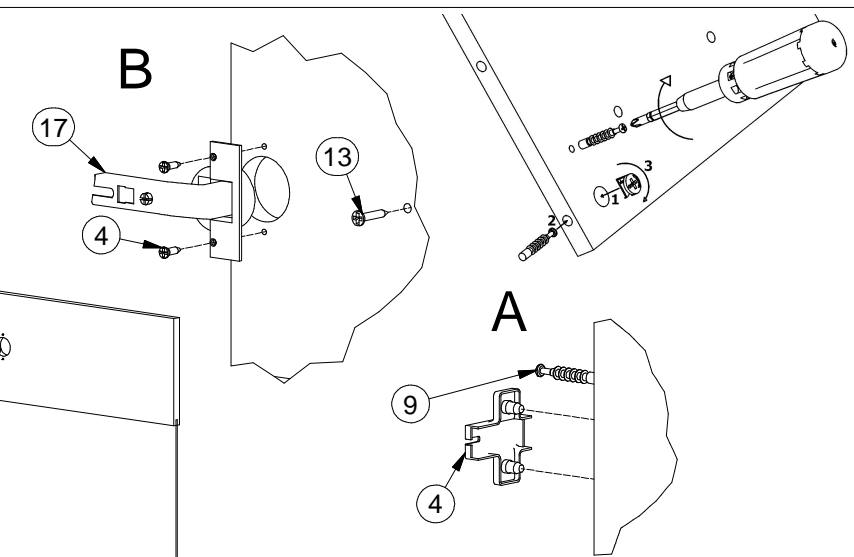
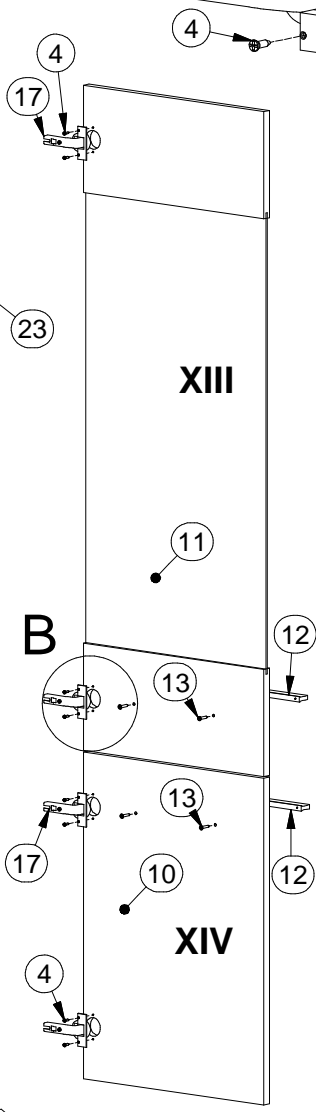
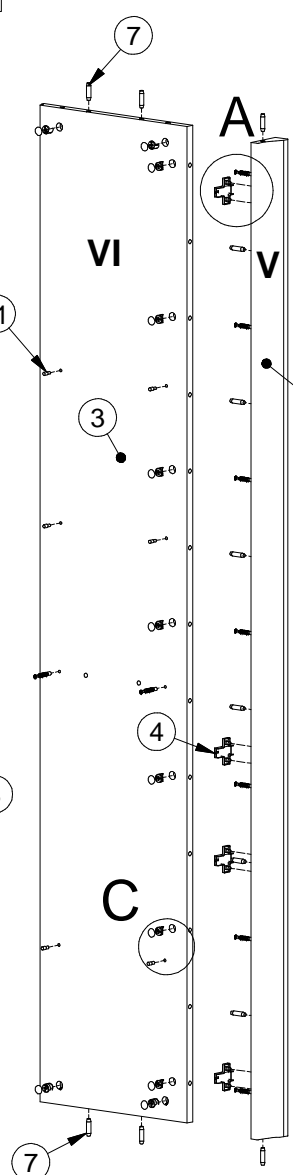
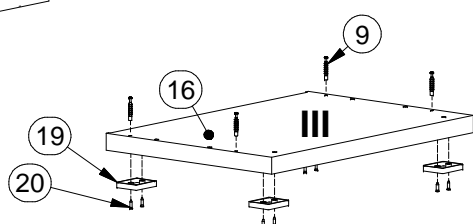
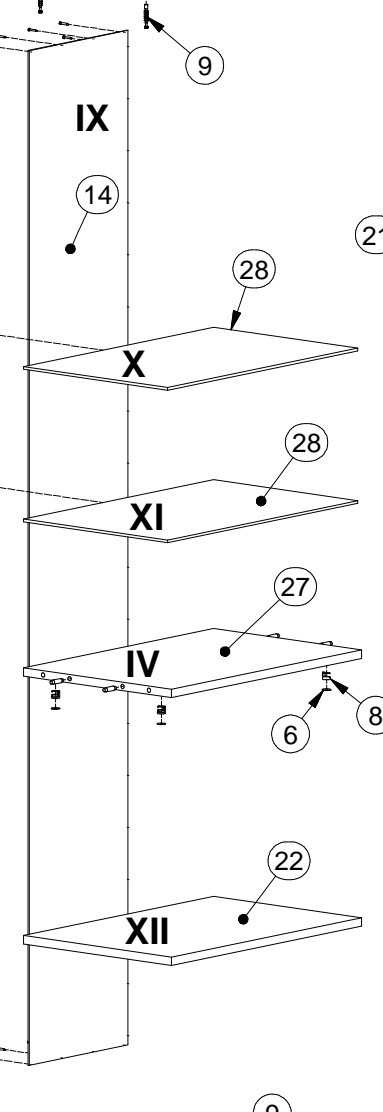
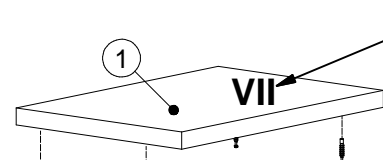
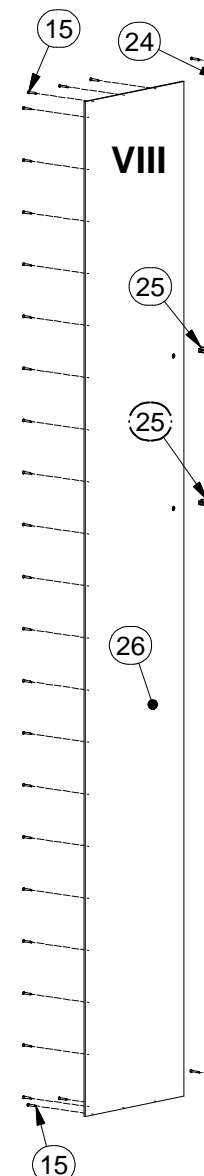
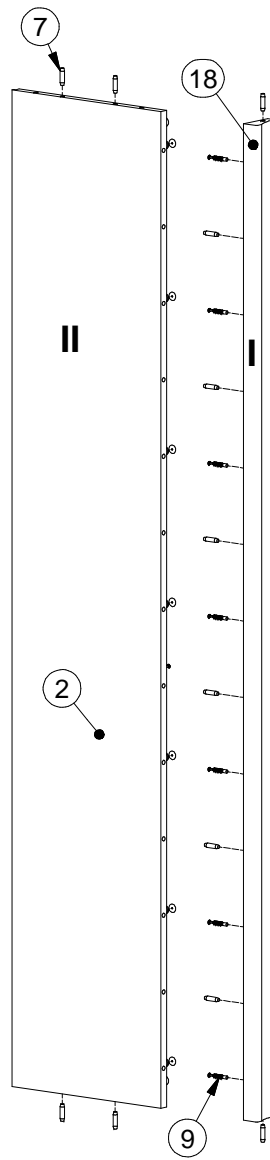

kolejność montażu

Lista części		
POZYCJA	ILOŚĆ	NUMER CZĘŚCI
1	1	Błat górny
2	1	Bok L
3	1	Bok R
4	4	Prowadnik zawiasu
5	8	Euro wkręt 6,3x13
6	26	Zaślepka mimośrod
7	28	Kołek
8	26	Puszka mimośrod
9	26	Trzpień mimośrod wkręcany
10	1	Drzwi R
11	1	Drzwi witr R
12	2	Uchwyt
13	4	Wkręt uchwytu 3x25
14	1	Ściana tylna
15	54	Gwoździe 3x20
16	1	Błat dolny
17	4	Zawias równoległy
18	1	Listwa L
19	4	Nóżka
20	8	Wkręt nóżki 4x16
21	12	Podpórka
22	1	Półka
23	1	Listwa R
24	1	Listwa H
25	2	Oświetlenie 2 punktowe
26	1	Ściana tylna wiercona
27	1	Przegroda pozioma
28	2	Półka szklana